

SWING DOOR

www.eswindows.com

ES-46T

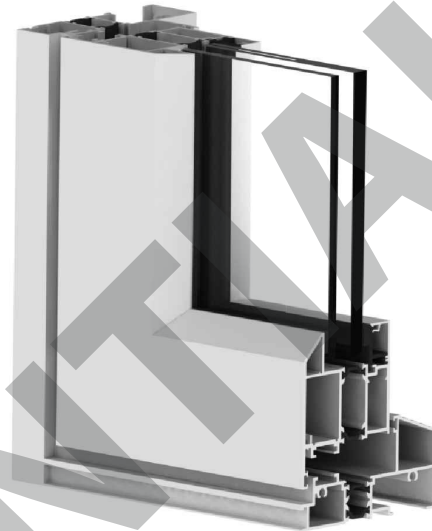

System Description

- Large missile impact and small missile impact.
- Frame depth: 4 1/2".
- Frame sight line: 4 7/8".
- Sill height: 4 1/2".

Features

- Optional strap anchor.
- Two point lock and three point lock handle.
- Compatible with window wall systems.
- Optional transom and sidelite.

Test

- Air infiltration: 6.24 psf
- Water infiltration: 15 psf
- Design load: +100 - 120 psf for single door +90 -100 for double door. See test report for further information.

Configurations



X

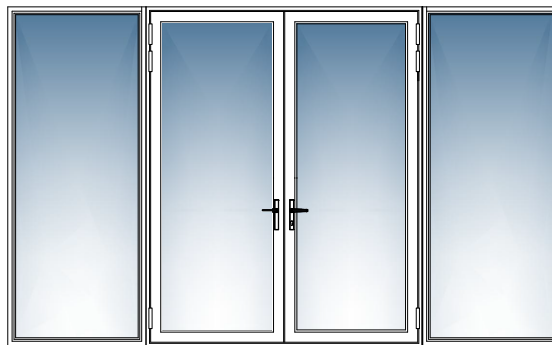

OXXO

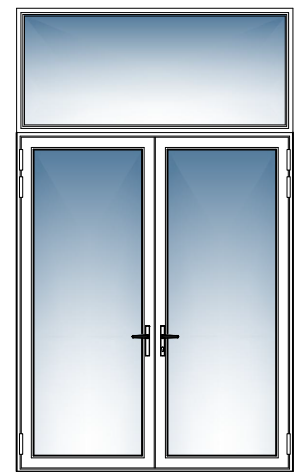

O/XX

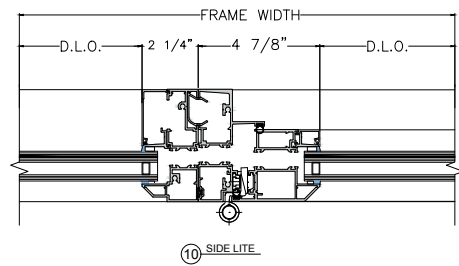
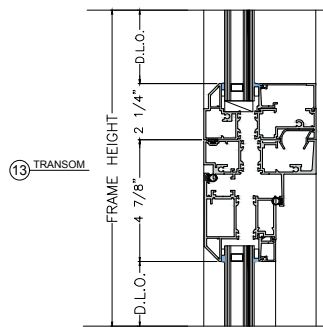
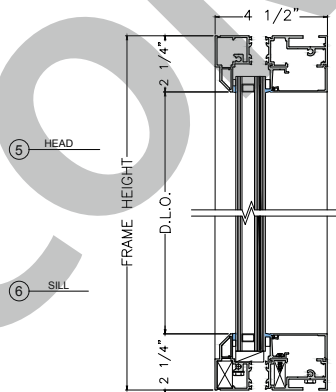
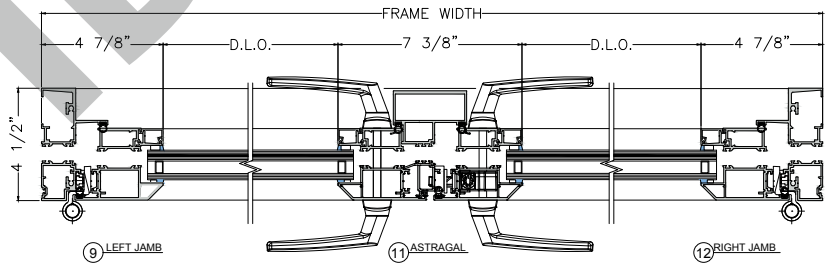
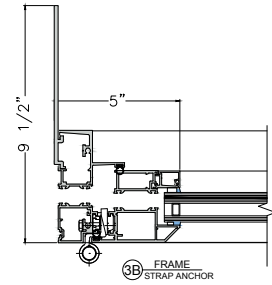
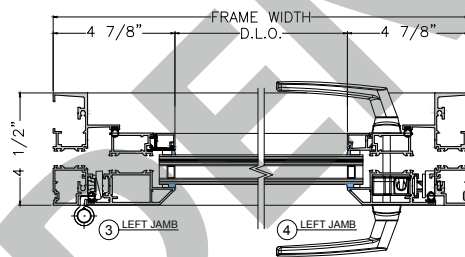
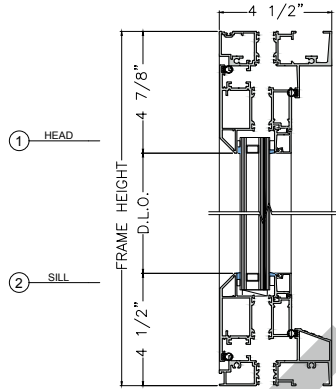
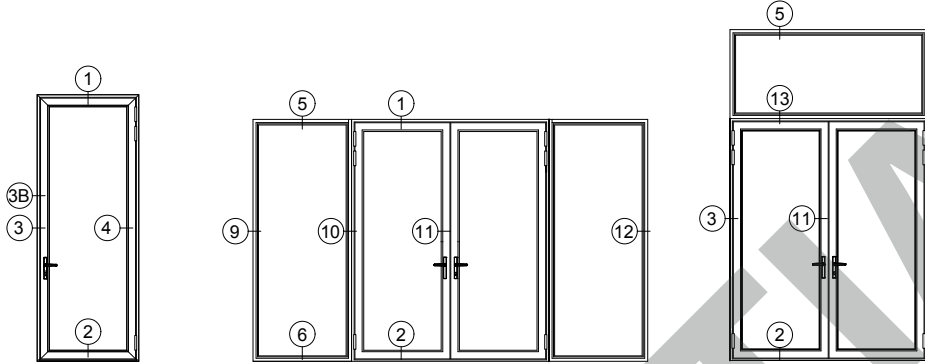

Glazing options

Insulating laminated glass

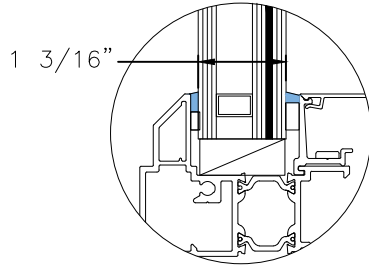

Designed for 1 3/16" Insulating laminated glass

Large missile impact: 3/16" H.S. glass+ .090" interlayer + 3/16" H.S. glass + 1/2" spacer + 1/4" Tempered glass.

Small missile impact: 3/16" H.S. glass+ .060" interlayer + 3/16" H.S. glass + 1/2" spacer + 1/4" Tempered glass.

GLASS FINISH:

PAINTED, SERIGRAPHY, DIGITAL PRINTED

For more information please contact TECNOGLASS® or visit www.tecnoglass.com

Aluminum

ALLOY 6063-T6
ALLOY 6005-T5

For more information about aluminum and finishes consult ALUTIONS®.

Sealant

APPROVED SILICONE SEALS:

WEATHERPROOFING SILICONE:

Used to seal profile unions to avoid air and water infiltration.

- Dowcorning 791 (Black-White)

STRUCTURAL SILICONE:

Besides acting as a sealant it is capable to support high loads. This silicone is commonly used to support the glass in facades and hurricane resistant products.

- Dowcorning 983
- Dowcorning 995

Measurements

Maximum sizes:

40" x 98" high per panel.